

SPECIFICATION
 Rating:DC 20V,4A
 Contact Resistance:30 Milliohms Max.
 After Test:50 Milliohms Max.
 Insulation Resistance:100 Megaohms Min.(500V DC)
 After Test:50 Megaohms Min.
 Withstand Voltage:500V AC
 Insertion And Extraction Force:3~30N
 Life Test:5000 Cycles Min.
 Operation Temperature Range:-20°C~+70°C
 Preservative Temperature Range:-40°~+85°C
 RoHS Compliant

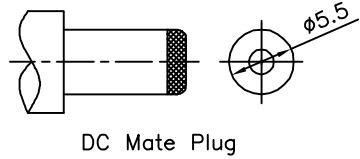
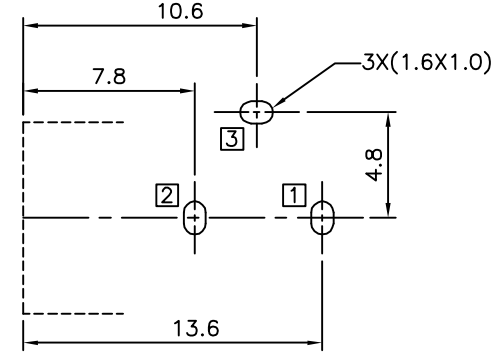
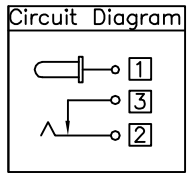

Recommended P.C.B. Layout(Bottom View)
 Unspecified Tolerance:±0.05

□:Terminal No.

⑥	Shunt Terminal	③	1	Brass	Tin Plated
⑤	Tip Spring	②	1	Phosphor Bronze	Tin Plated
④	Center Pin Terminal	①	1	Brass	Tin Plated
③	Center Pin	①	1	Brass	CuSn Plated
②	Cover		1	PBT UL94V-0	Black
①	Housing		1	PBT UL94V-0	Black
No.	Description		Q'ty	Material	Remark

4U CON 元化興業股份有限公司
 4U CON TECHNOLOGY INC.

DRAWING No.		APPROVED BY		UNLESS OTHERWISE SPECIFIED TOLERANCES ARE X. ±0.3 .X ±0.3 ANG. ±2°
18742		EMILY		
		CHECKED BY		
		HZF		
		DRAWING BY		
		HAO		
SCALE	NONE	REV.	BO	UNIT mm

△ BO	NEW RELEASE	HZF	01/12/2015
NO. REV.	REVISIONS	CHK	DATE