

HSF RoHS

Insoulstor type: Opem frame

Contact	Dim A	Dim B	Dim C	Dim D
4	5.08	2.54	7.62	10.16
6	7.62	5.08	7.62	10.16
8	10.16	7.62	7.62	10.16
10	12.70	10.16	7.62	10.16
14	17.78	15.24	7.62	10.16
16	20.32	17.78	7.62	10.16
18	22.86	20.32	7.62	10.16
20	25.40	22.86	7.62	10.16
24	30.48	27.94	7.62	10.16
28	35.56	33.02	7.62	10.16
20	25.40	22.86	10.16	12.70
22	27.94	25.40	10.16	12.70
24	30.48	27.94	10.16	12.70
28	35.56	33.02	10.16	12.70
24	30.48	27.94	15.24	17.78
28	35.56	33.02	15.24	17.78
32	40.64	38.10	10.16	12.70
32	40.64	38.10	15.24	17.78
36	45.72	43.18	15.24	17.78
40	50.80	48.26	15.24	17.78
42	53.34	50.80	15.24	17.78
48	60.96	58.42	15.24	17.78
50	63.50	60.96	15.24	17.78
52	66.04	63.50	15.24	17.78
50	63.50	60.96	22.86	25.40
52	66.04	63.50	22.86	25.40
64	81.28	78.74	22.86	25.40

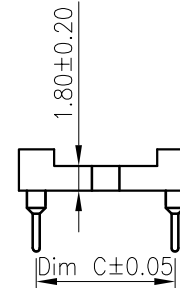
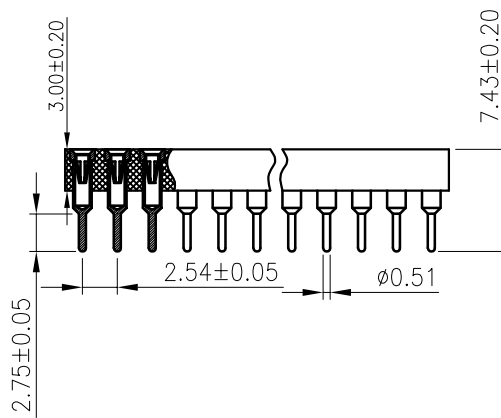
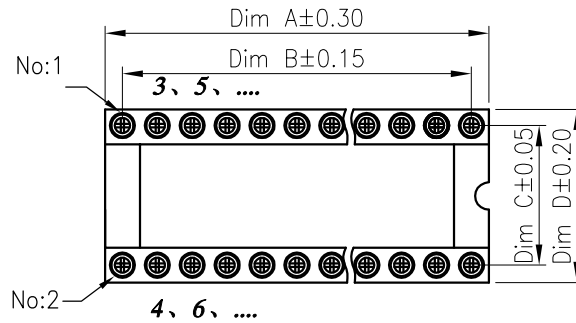

Recommended P.C.B Layout(Top Side)
(PCB BOARD TOLERANCE±0.05)

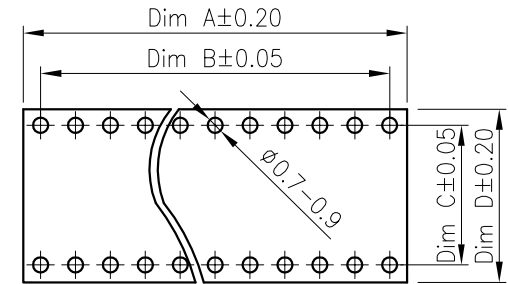

Ordering Information

7210- 30 X XX S XX 074 0 1

N=7.62PH
 E=10.16PH
 W=15.24PH
 Y=22.86PH
 No.of Pins
 6~64Pins
 Connector Type
 G0=Gold Flash
 S0=Gold Flash/Tin
 S3=10u" Gold/Tin
 S4=15u" Gold/Tin
 S5=30u" Gold/Tin
 Pin Length
 074=7.43mm
 Packing
 0=Pe Bag
 T=Tube

Technical Specs:

Insulator: Black glass filled polyester PBT/PPS
 Flammability: UL 94V-0
 Sleeve: Brass
 Contact clip(4/6 finger): Beryllium copper(C17200/C17530)
 Accepted pin: Ø0.40 to 0.56mm
 Forces: (polished steel gauge Ø0.43mm)
 Mechanical life: min100 cycles
 Rated current: 3.0A
 Contact resistance: max 20mΩ
 Dielectric resistance: 1000MΩ Min
 Voltage:1000V
 Humidity:MSL Level :2
 Operation Temperature: -40°C to +105°C

OPERATION		DRAW	YiYuSheng	14.03.28	SCALE	FIT
X.X	±0.30					
X.XX	±0.20	CHECK			UNIT	mm
X.XXX	±0.10				SIZE	A4
Angle	±3°	APPROVE			SHEET	1/1
DIM	TOL				PROJ.	◆

JILN 深圳市锦凌电子有限公司
SHENZHEN JINLING ELECTRONIC CO.,LTD
Tel: 86-755-2997-5806/5802 Fax: 86-755-2997-5992

AO	DATE	MODIFICATION DESCRIPTION	CHANGE
REV	DATE	MODIFICATION DESCRIPTION	CHANGE

PART NO.	721030XXXSXX07401
TITLE:	2.54x3.00 Machine Pin IC Socket L=7.43mm