

RECOMMENDED
PANEL CUTOUT

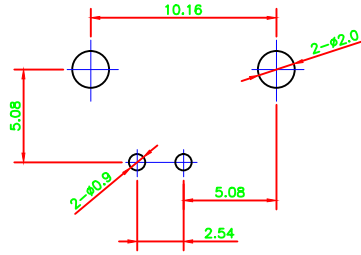

RECOMMENDED
PCB LAYOUT

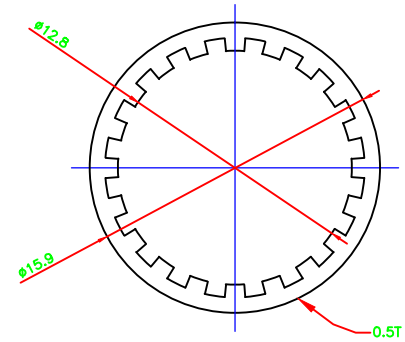
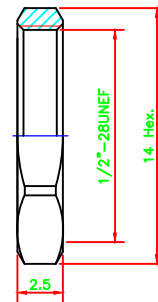

NO	Description	Material	Finish
1	Body	Zinc	Nickel
2	Contact	P.H Bronze	Gold
3	Insulator	Polypropylene	-
4	Housing	PBT+15% G.F.	White
5	Nut	Brass	Nickel
6	Washer	Brass	Nickel
7	Mounting Post	Brass	Tin
8	Grounding Terminal	Copper	-

Dimensions Are In Millimeters
Unless Otherwise Specified
Tolerances

0.5-6 = ± 0.2
6-30 = ± 0.4
30-120 = ± 0.6
120-315 = ± 1.0
315-1000 = ± 1.6
1000-2000 = ± 2.4

ROHS COMPLIANT

COSMTEC COSMTEC RESOURCES CO., LTD

DRAFT	CHECKED	APPROVED
-------	---------	----------

The Drawing Contains Information That Is Proprietary To Cosmtec Resources Co., Ltd And Should Not Be Used Without Written Permission. www.cosmtec.com

Part No.	B-057-HP
Title:	BNC HIGH PROFILE R/A FOR PCB 50Ω (White Housing)
DATE:	SEP/22/2016
SCALE:	1:1
UNIT	m/m
REV	A