

A-A SECTION

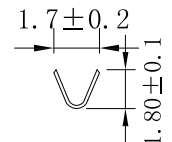

B-B SECTION

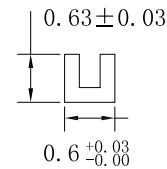
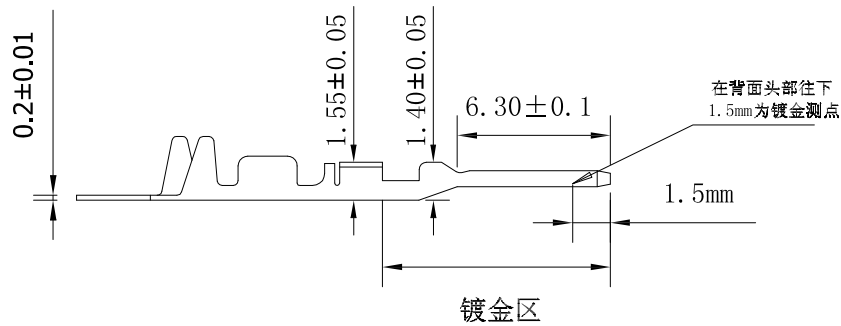

技术参数: SPECIFICATIONS

适用线规: AWG#22~#28

Applicable wire: AWG#22~#28

额定电压: 250V DC/AC (有效值)

Voltage rating: 250V DC/AC (rms)

额定电流: 2.5-1.0A

Current rating: 2.5-1.0A

耐压值: 800V AC(有效值)

Withstand voltage: 800V AC(rms)

工作温度: -25 °C~+85 °C

Working Temperature: -25 °C+85 °C

绝缘电阻:  $\geq 1000M \Omega$

Insulation resistance:  $\geq 1000M \Omega$

接触电阻:  $\leq 0.02 \Omega$

Contact resistance:  $\leq 0.02 \Omega$

东莞市红扬电子有限公司

				料号PART NO:				一般公差 GENERAL TOLERANCE X.X ±0.15 X.XX ±0.05 ANGLE ±1°
				品名 TITLE:				
材料: 黄铜		单位: MM		包装规格: 10K/卷		比例: 1:1		
日期版次 REVISION	日期 DATE	变更内容 DESCRIPTION	核 准 APPROVALBY	制图: LI	审核: LI	核准: LI	日期: 2010/02/22	

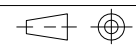

6

5

4

3

2

1