

MARK	DATE	ECN NO.	DESCRIPTION	REV.	DESIGN

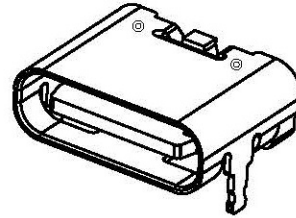
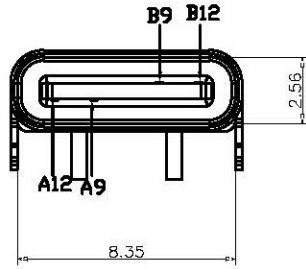
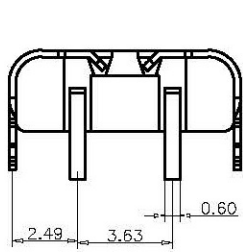

备注 (NOTE):

1. 材质:

1. 1. 胶芯: LCP UL94 V-0

1. 2. 端子: C2680, T=0.2mm; 镍底, 镀金

1. 3. 外壳: 不锈钢201-H 表面镀镍

2. 电气特性:

2. 1. 接触区: 接触电阻40mΩ Max, 允许10mΩ变化量. 测试条件: 20mv, 100mA下测量.

2. 2. 接触电流: 3A VBUS引脚; 1.25A用于GND引脚; 其他引脚为0.25A.

2. 3. 额定电压: 5V.

2. 4. 耐电电压: 100VAC.

2. 5. 绝缘电阻: 至少100兆欧 .

3. 机械性能:

3. 1. 插入力: 0.5-2.0Kg

3. 2. 拔出力: 0.6-2.04Kg

3. 3. 插拔次数: 5000次.

4. 工作环境: -20℃ to +85℃.

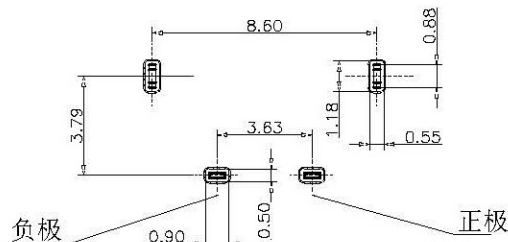
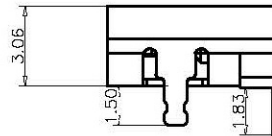
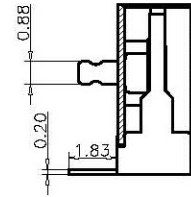
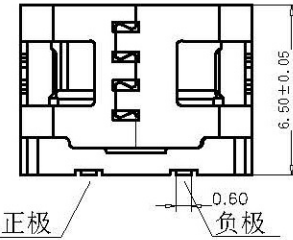
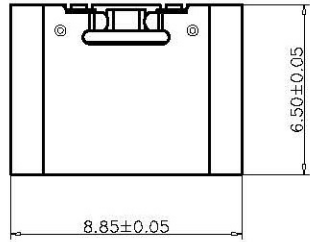

RECOMMEND P.C.B LAYOUT (COMPONENT SIDE)  
TOLERANCE FOR PCB LAYOUT IS ±0.05



長熒有限公司

TEL: 02-26945824 FAX: 02-26946971

UNLESS OTHERWISE SPECIFIED TOLERANCE			
ANG	TOL	DIM	TOL
X.°	±4.0°	.X	±0.30
X.X'	±3.0'	.XX	±0.20
X.XX'	±2.0'	.XXX	±0.05

DRAW NO.	TITLE		TYPE-CF 2P 两脚插板 DIP 脚长 1.6			
DESIGN	XIAO XU	MAT'L	Please see P/N information			
VERIFIED	TANDY	SEE TABLE	PART NO.			
APPROVED	Z.W.H	DATE	UNITS	SCALE	PAGE	SIZE
		06/05'20	mm	1:1	1/1	A4