



GL6F22A

TECHNICAL SPECIFICATION FOR ALKALINE MANGANESE DIOXIDE BATTERY

DATE: 9/15/2005

SPEC. NO.: ES-GL6F22A

REVISION: 2005C

GOLDEN POWER CORPORATION (HK) LTD.

Flat C, 20/F, Block 1, Tai Ping Industrial Centre, 57 Ting Kok Road, Tai Po, N.T., Hong Kong

Tel: (852) 3125 2288 Fax: (852) 3125 2000 / (852) 3125 2001

E-mail: battery@goldenpower.com Web Page: <http://www.goldenpower.com>

8. Marking

The following markings will be printed, stamped or impressed on the body of the battery:

- (1) Designation : GL6F22A
- (2) Manufacturer's name or abbreviation **"Golden Power Logo"**
- (3) Polarity: "+" or "-"
- (3) Warning: Battery may explode or leak if recharged or disposed of in fire

9. Caution for use

- (1) Since the battery is not manufactured for recharging, there are risks of electrolyte leakage or causing damage to the device if the battery is charged.
- (2) The battery shall be installed with its "+" and "-" polarity in correct position, otherwise may cause short-circuit.
- (3) Short-circuiting, heating, disposing of into fire and disassembling the battery are prohibited.
- (4) Battery cannot be forced discharged, which lead to excess gassing and, may result in bulging, leakage and de-crimping of cap.
- (5) New and used batteries cannot be used at the same time, when replaced batteries recommend to replace all and with the same brand type.
- (6) Exhausted batteries should be removed from compartment to prevent over-discharge, which cause leakage _damage to the device.
- (7) Direct soldering is not allowed, which will damage the battery.
- (8) Battery should be kept out of the reach of children to prevent swallow, in case of accident should contact physician at once.

10. Shelf Life 3 years after delivery under proper storage conditions.
(Temperature: 20+/-2°C; Relative humidity: 65+/-20%RH)

11. Discharge Curves (Condition: Test temperature 20+/-2°C)

Discharge Method: 180Ω 30 m/d (Ref to the Figure 1)

Discharge Method: 620Ω 2 h/d (Ref to the Figure 2)

12. Battery Structure and Dimension: Ref to Drawing DWG-S001

GOLDEN POWER CORPORATION (HK) LTD.

Figure 1: GL6F22A DISCHARGE CURVE

Discharge Method: 180 ohm; Period: 30 m/d

Temperature: 20+/-2°C

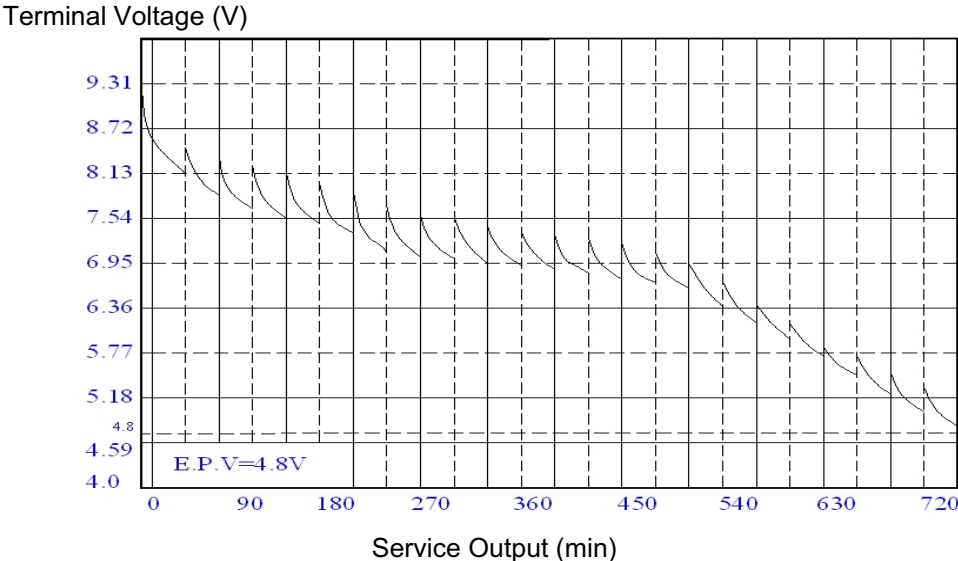
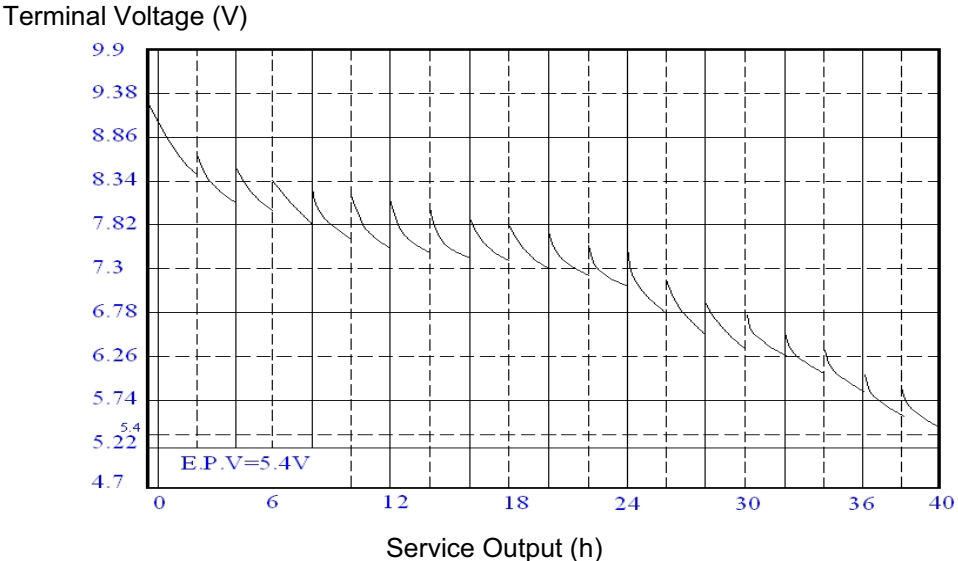

Figure 2: GL6F22A DISCHARGE CURVE

Discharge Method: 620 ohm; Period: 2 h/d

Temperature: 20+/-2°C



GL6F22A BATTERY DIMENSION AND STRUCTURE

GL6F22A 電池外形及尺寸

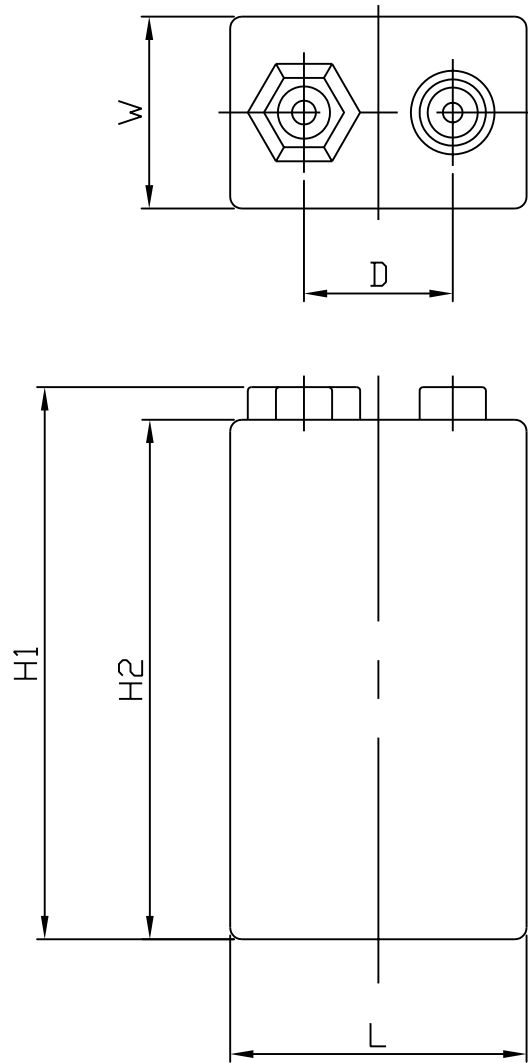

L : 25.5±1.0
W : 16.5±1.0
H1 : 47.5±1.0
H2 : 46.4 Max
D : 12.7±0.25

GOLDEN POWER CORPORATION (HK) LTD.

金力企業(香港)有限公司

MODEL(型號): GL6F22A

DWG No.(圖號): DWG-S-001

SCALE(比例): NTS DIM(單位): mm

Approved by (審核):

DATE(日期): 15/9/05 DRAWN BY(繪制): Kelvin

Cecilia Chu

TOLERANCES (公差) LINEAR ±1 3rd ANGLE PROJECTION
ANGULAR ±1/4° (第三角度視圖)