

*開關產品未經SWITRONIC同意，請勿拆解，否則無法負品質及安全責任。
Please do not decompose the switch without any permission from SWITRONIC,
otherwise the quality and safety responsibility could not be guaranteed.

*本圖面若與目錄之規格尺寸不符，以本圖面規格尺寸為主。
Below is our main specification if different from catalog.

RoHS compliant

※ Reference only
(2019.12.18)

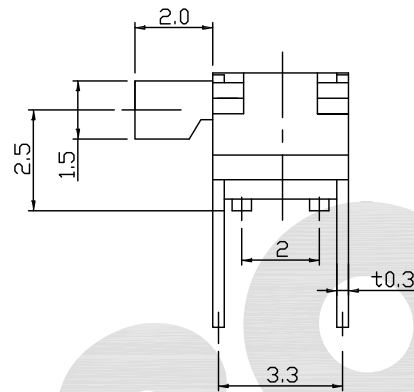
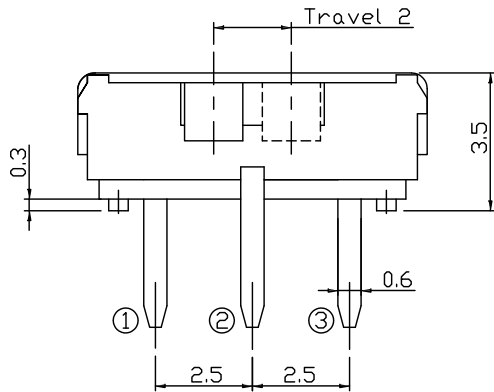

SCHEMATIC

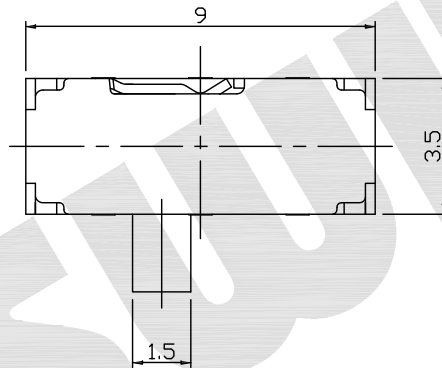
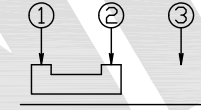

P.C.B. LAYOUT

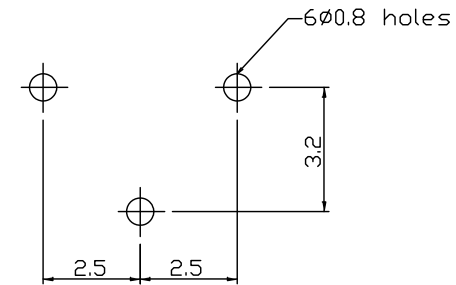

SPECIFICATION

Rating: 0.3A 6V DC.
Travel: 2.0±0.3mm.
Contact resistance: 70mΩ Max.(initial)
Operating force: 200±100g.
Life: 10,000 Cycles.
Soldering temperature: 250°C Max. for 3 seconds.
Soldering time: 1 time only.

Note1: Unwashable, don't be immersed by epoxy and organic solvent.
Note2: Please do not scale the drawing comparing to real product and kindly measure the size of real product.

STORAGE METHOD

After opening the bag of the switches, please include a desiccant into the bag, then seal it to avoid product oxidation.

打開包裝袋後，請在袋中加入乾燥劑並「密封」，避免產品氧化。

| | | | | |
|----------------|------------------|-------------------|-----------------|-----------------------|
| 產品 PRODUCT | Slide Switch | | 型號 MODEL NO. | IS-1245T-G |
| 製圖 DRAWN BY | 核圖 CHECKED BY | 主管 APPROVED BY | 單位 UNIT | mm |
| Eddie Chien | Chuck Young | Margaret Lee | 比例 SCALE | 4 : 1 |
| | | | 公差 TOLERANCE | .X=±0.3mm, .XX=±0.2mm |

SWITRONIC[®]
INDUSTRIAL CORP.
Switches



一綺電子企業股份有限公司

總公司：110 台北市信義路四段415號13樓之3
13F-3, NO.415, SEC.4, HSIN YI ROAD, TAIPEI, TAIWAN
TEL : 886-2-27290229(Rep.) FAX : 886-2-27582086
URL : www.switronic.com E-MAIL : switches@ms36.hinet.net