

0.36" Red & Yellow Green Dual Color Four Digit Display
OSL40363-IRYG (Common Anode type)
OSL40363-LRYG (Common Cathode type)

■ **Features**

- 0.36 Inch Four Digit Display
- Long lifetime operation
- IC compatible
- Low power dissipation
- Black surface & white segment or dot

■ **Applications**

- Counting device
- Clock

Item	Symbol	Value		Unit
		Red	YG	
DC Forward Current	I _F	20	20	mA
Pulse Forward Current#	I _{FP}	100	100	mA
Reverse Voltage	V _R	5	5	V
Power Dissipation	P _t	52	52	mW
Operating Temperature	Topr	-30 ~ +70		°C
Storage Temperature	Tstg	-40~ +85		°C
Lead Soldering Temperature(1.6mm from seating plane)	Tsol	260°C/5sec		°C

■ **Absolute Maximum Rating** (Ta=25°C)

#Pulse width Max.10ms Duty ratio max 1/10

■ **Electrical -Optical Characteristics** (Ta=25°C)

Part Number	Color		V _F (V)* ₁			I _R (μA)	I _v (mcd)* ₂			λD(nm)* ₃		
			Min.	Typ.	Max.	Max.	Min.	Typ.	Max.	Min.	Typ.	Max.
			I _F =20mA			V _R =5V		I _F =20mA				
OSL40363-IRYG	Yellow Green	YG	-	2.1	2.6	20	-	12	-	565	570	575
	Red	R	-	2.1	2.6	20	-	20	-	620	630	640
OSL40363-LRYG	Yellow Green	YG	-	2.1	2.6	20	-	10	-	565	570	575
	Red	R	-	2.1	2.6	20	-	16	-	620	630	640

*₁ Tolerance of measurements of forward voltage is ±0.1V

*₂ Tolerance of measurements of luminous intensity is ±15%

*₃ Tolerance of measurements of dominant wavelength is ±1nm

Package Dimensions and Pin Function

**OSL40363-IRYG
(Common Anode type)**

Note:
1, Unit : mm(Tolerance:±0.25mm unless otherwise noted)
2, The slope angle of any PIN may be±5.0°Max

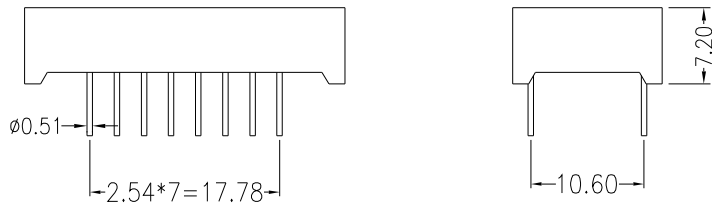
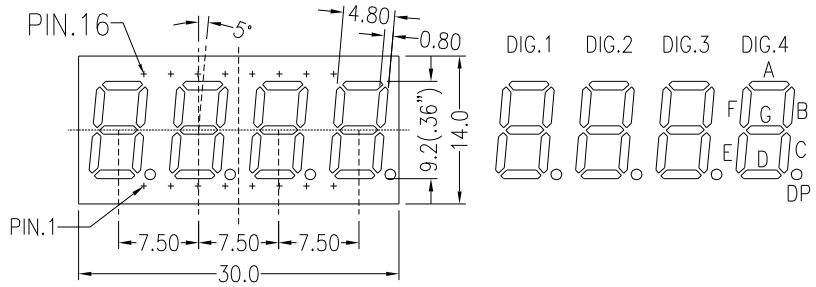

Yellow green

Red

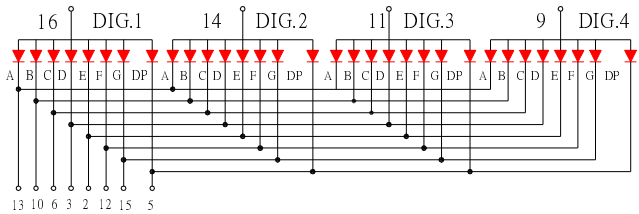
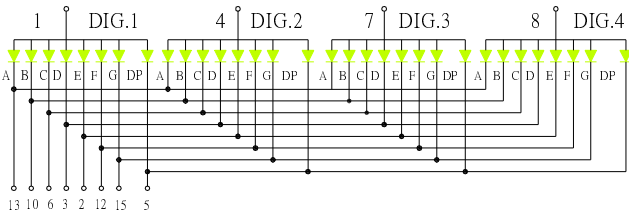

**OSL40363-LRYG
(Common Cathode type)**

Note:
1, Unit : mm(Tolerance:±0.25mm unless otherwise noted)
2, The slope angle of any PIN may be±5.0°Max

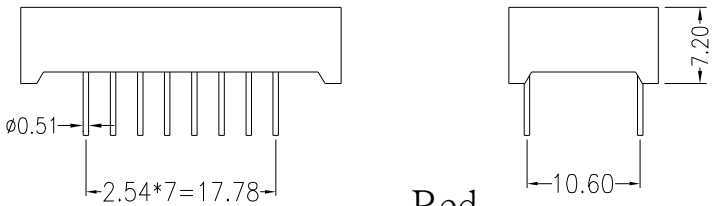
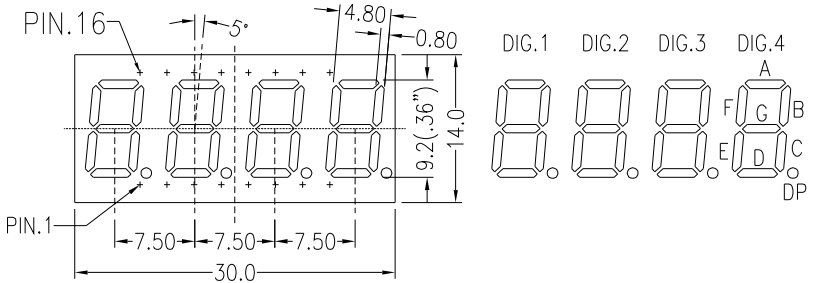

Yellow green

Red

