

\*開關產品未經SWITRONIC同意，請勿拆解，否則無法負品質及安全責任。  
 Please do not decompose the switch without any permission from SWITRONIC,  
 otherwise the quality and safety responsibility could not be guaranteed.  
 \*本圖面若與目錄之規格尺寸不符，以本圖面規格尺寸為主。  
 Below is our main specification if different from catalog.

RoHS compliant

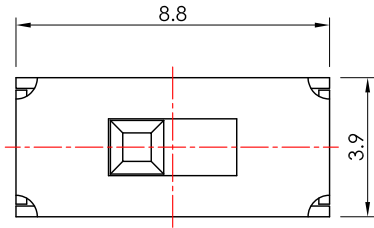

P.C.B. LAYOUT

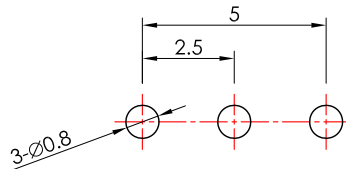

SCHEMATIC

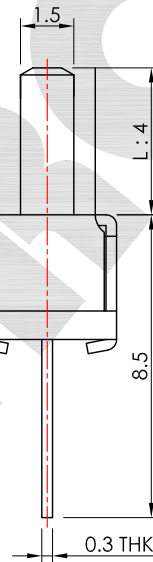
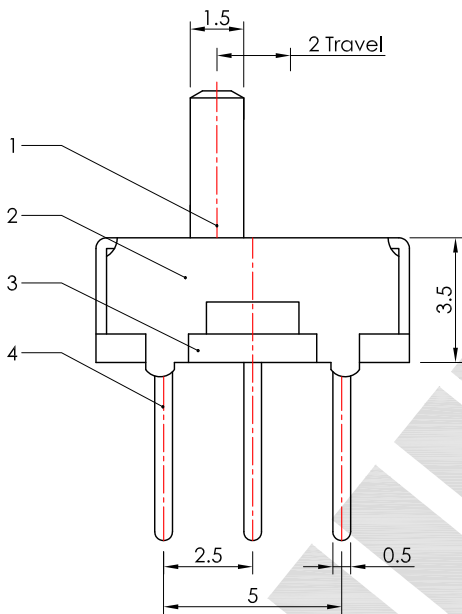
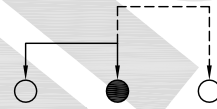

RoHS compliant

SS12D01GX-G

OPTIONAL KNOB SIZE (L)

2 - 6

**SPECIFICATION**

**Rating:** 0.3A 50V DC.  
**Timing:** Non-shorting.  
**Contact resistance:** 30mΩ Max.(initial)  
**Insulation resistance:** 100MΩ at 500V DC.  
**Withstand voltage:** 500V AC for 1 minute.  
**Operating force:** 200±80g.  
**Life:** 10,000 Cycles Min.  
**Soldering temperature:** 230°C Max. for 2±0.5 seconds.  
**Soldering time:** 1 time only.  
**Note 1:** Unwashable, don't be immersed by epoxy and organic solvent.  
**Note2:** Please do not scale the drawing comparing to real product and kindly measure the size of real product.

**MATERIAL**

**Knob:** POM, black. ①  
**Frame:** Steel strip, Ni plated. ②  
**Base:** Phenolic resin, natural. ③  
**Terminal:** Brass strip, Ag plated. ④  
**Contact clip:** PBS strip, Ag plated. ⑤

**STORAGE METHOD**

After opening the bag of the switches, please include a desiccant into the bag, then seal it to avoid product oxidation.  
 打開包裝袋後，請在袋中加入乾燥劑並「密封」，避免產品氧化。



V2.2	無	改版	2015.07.01
V2.1	無	改版	2009.08.26
V2.0	無	新繪製	2004.11.03
版本 VER.	符號 SYMBOL	修改內容 ALTERATION	更新日期 DATE

<b>產品</b> PRODUCT		<b>Slide Switch</b>		<b>型號</b> MODEL NO.		<b>SS12D01G4-G</b>	
比例 SCALE	5 : 1	單位 UNIT	mm	<p style="text-align: right; font-weight: bold; margin-top: 10px;">一綺電子企業股份有限公司</p> 總公司：110 台北市信義路四段415號13樓之3 13F-3, NO.415, SEC.4, HSIN YI ROAD, TAIPEI, TAIWAN TEL : 886-2-27290229(Rep.) FAX : 886-2-27582086 URL : www.switronic.com E-MAIL : switches@ms36.hinet.net			
公差 TOLERANCE	.X=±0.3mm, .XX=±0.2mm						
製圖 DRAWN BY	核圖 CHECKED BY	主管 APPROVED BY					
<i>Peter Kuo</i>		<i>Chuck Young</i>					
<i>Margaret Lee</i>		<i>Margaret Lee</i>					