

1 2 3 4 5 6 7 8 9 10

A
B
C
D
E
F
G

A
B
C
D
E
F
G

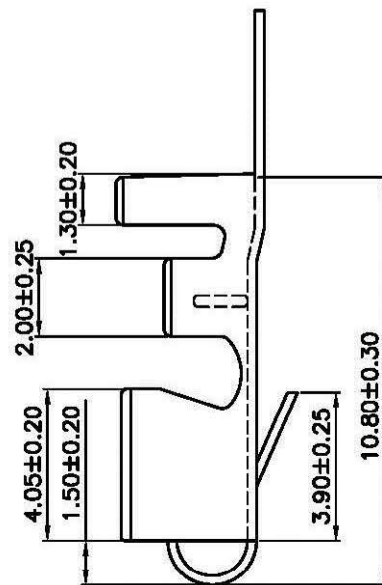
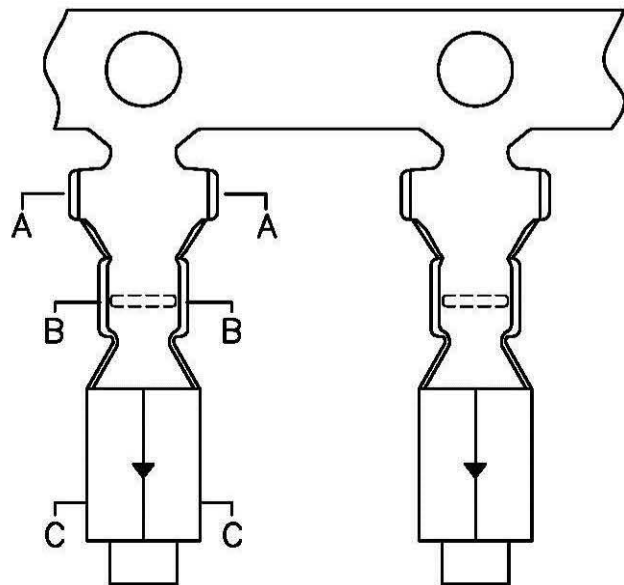

SPECIFICATIONS

Voltage Rating: 250V AC/DC
 Current Rating: 7A AC/DC
 Withstanding Voltage: 1500V AC/minute
 Insulation Resistance: 1000MΩ min.
 Temperature Range: -25° C - +85° C
 Contact Resistance: 20mΩ max

TERMINAL

Wire Range: AWG#18-#22 (OD3.0mm max)
 Material: Phosphor Bronze
 Finish: Tin Plated
 Thickness: 0.25mm
 Q'TY: 3,000PCS/Reel

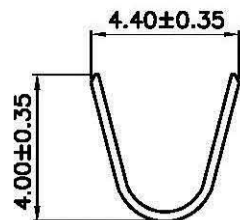

A-A

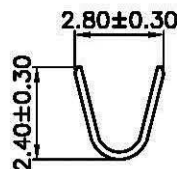

B-B

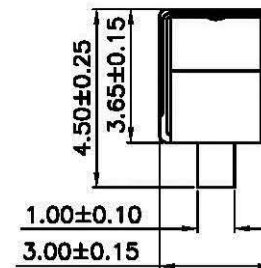

C-C

						OPERATION	DRAW	JACKY	2005.03.18	SCALE	Chang Enn Co., Ltd.	
						~ 10 ±0.15	DESIGN			UNIT	mm	
						20 ~ 30 ±0.30	CHECK		2005.03.18	SIZE	A4	PART NO. SVH-21T-P1.1C
0	05/12/27	NEW				30 ~ ±0.50	APPROVE	ALEX	2005.03.18	SHEET	1/1	TITLE: 3.96 TERMINAL
REV	DATE	MODIFICATION DESCRIPTION	CHANGE	APPROVE	Angle DIM	± 2° TOL	APPROVE	ALEX	2005.03.18	PROJ.	↻	DRAWING NO.

1 2 3 4 5 6 7 8 9 10