

Industrial Control

Metal Button

Automation Components

J16金属按钮



温州金宏电器有限公司
WENZHOU JINHONG ELECTRICAL APPLIANCE CO., LTD

J16金属按钮开关 Metal button switch



■ 特性 / Features

- 安装直径16mm
- 防护等级：IP65/IP67/IK10
- 触点银镀金：3μ
- LED超高亮冷光源灯显示
- 可定制图案，颜色及尺寸

公司电子样本浏览手机网站

www.wzjh.cc

了解公司最新动态及相关信息与成功应用情况



免费下载

www.wzjh.cc

免费的产品与技术支持，可从一处立刻下载



■ 符合标准 / Standard

符合IEC60947-5-1 GB14048.5标准
Conform to IEC60947-5-1 GB14048.5 Standard

■ 触点方式

Contact Style

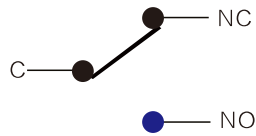

■ 端子描述

Terminal Description

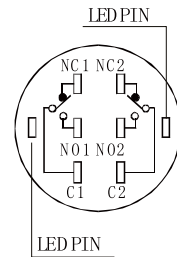

■ 安装尺寸 / Install Size

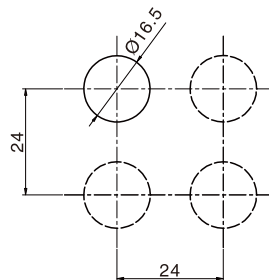

■ 连接器 / Connector

快速连接，安全使用，方便连接，
线长可供定制。

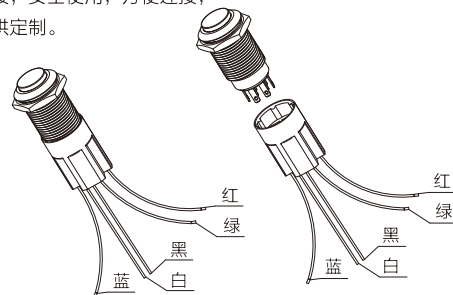

J16连接器

■ 开关结构说明 / Switching Operation

型式Type	No.1	No.2	No.3
符号Sign			
示意图Diagram			
说明Explanation	<p>具有两个端子的双断电慢动触头开关个别产品可定制Y型常闭开关，详见产品说明 Using two terminals, double-break and slow-motion contact. Y type NC switch can be made to order for individual product, pls check the product description.</p>		

■ 额定参数/ Rating

工作电压 Working voltage		24V	110V	220V	
接触参数 Contact Parameter	AC (50/60Hz)	阻性	—	1.0A	0.5A
		感性	—	0.7A	0.5A
	DC	阻性	1.0A	0.2A	—
		感性	0.7A	0.1A	—

J16 金属按钮开关命名方式 The naming definition of J16 metal push button switch

J16	-					-	
安装尺寸 Install Size	动作方式 Action Style:	头部形状 Shape of Top:	触点形式 Contact Type:	颜色/Color:	电压/Voltage:	材料/Material:	
	2:自复按钮 3:自锁按钮 2:Momentary 3:Maintained	1:平头 2:高位头 3:弧面头 6:高面带灯 7:平面带灯 8:点头带灯 9:高点面带灯 1: Flat Round 2: High Round 3: Domed 6: High Ring Illumated 7: Ring Illumated 8: Dot Illumated 9: High Dot Illumated	1:1NO+1NC 2:2NO+2NC	R 红色 / Red G 绿色 / Green B 蓝色 / Blue W 白色 / White Y 黄色 / Yellow	D:24VDC E:12VDC F:6.3VDC A1:110VAC A2:220VAC	Ni:不锈钢 T:铜镀镍 G:铜镀铬 Ni:Stainless steel T: Copper Plated Ni G: Copper plated Cr	

注：常规的定制都是不锈钢外壳，如需铜镀镍外壳，请在型号后面加T；如需铜镀铬外壳，请在型号后面加G

Note: The regular material is Stainless steel, if you want Copper Plated with Ni, please add T behind, if you want Copper Plated Cr, please add G behind.

触点规格 Contact Ratings

额定绝缘电压 Rated insulation voltage	250					
发热电流 Heating current I _{th}	3A温度不超过最大额定值所允许的电流 Temperature does not exceed the maximum allowed current					
额定使用电压 Rated voltage	12V	24V	110V	220V		
额定使用电流 Rated current	交流AC 50/60Hz	电阻性负载 Resistive load	-	5A	3A	
		电感性负载 Inductive load	-	3A	2A	
	直流DC	电阻性负载 Resistive load	5A	5A	1A	0.5A
		电感性负载 Inductive load	2A	2A	0.2A	0.1A
触点材料 Contact material	银镀金 Silver Plated Gold					

灯珠规格 Lamp Ratings

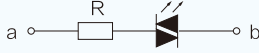
灯珠类型 Lamp Type	双向LED灯珠(交直流通用) LED lamp(AC/DC)
额定电压 Rated Voltage	3V,6V,12V,24V,36V,110V,220VAC/DC
额定电流 Rated Current	约15mA 约2mA About 15mA About 2mA
发光颜色 LED Color	R G Y O B W
寿命 Life	40000小时(参考值) 40000 hours(Reference)
灯珠等效电路 Lamp Circuit diagram	 <p>内置电阻：采用6V灯珠，需外接电阻。 采用交直流通用的LED灯珠，接线端子无正负极区分；60V以下灯珠已内置保护电阻； Using AC/DC LED lamp, the terminals have no difference of anode and cathode: Using inner resistance for the lamp below 60V. Using 6V lamp when the lamp voltage is above 60V, and need connect outer dropping resistance.</p>

注：如需单向直流LED灯珠可定做；其他电压规格可按需求定做。
DC LED and other voltage can be made to order.

J系列三色灯金属按钮

带电源符号按钮

金属信号灯

经济型金属按钮

金属按钮

Ø12
金属按钮

Ø16
金属按钮

Ø19
金属按钮

Ø22
金属按钮

Ø25
金属按钮

Ø30
金属按钮

Ø40
金属按钮

防水型金属按钮

Ø12
金属按钮

Ø16
金属按钮

Ø19
金属按钮

Ø22
金属按钮

Ø25
金属按钮

Ø30
金属按钮

Ø40
金属按钮

主要技术参数 Technical Parameter

保护等级/Degree of Protection	IP67
触点类型/Contact Type	C:1NO+1NC/2NO+2NC
最大电压/Maximum Voltage	250V AC/DC
热流/Thermal Current	3A
最小负载/Minimum Applicable Load	5V AC/DC, 1mA
触点材料/Contact material	Silver plated glod
端子形式/Terminal Style	.110" Solder/ Quick Connect
运行温度/Operating Temperature	-25° to +55°C
操作湿度/Operating Humidity	45 to 85% RH
接触电阻/Contact Resistance	50MΩ maximum
绝缘电阻/Insulation Resistance	100MΩ minimum (500V DC megger)
震荡电阻/Vibration Resistance	10 to 55Hz, amplitude 1.2mm p-p
保护等级/Degree of Protection	>10g
电气寿命/Electrical Life	100,000 operations minimum (at full rated load)
机械寿命/Mechanical Life	Maintained: 1,000,000 operations minimum Momentary: 1,000,000 operations minimum
耐压/Dielectrical Life	Switch Unit: 2,000V AC, 1 min. between live/dead part and terminals of different poles; 1,000V AC, 1 minute between terminals of the same pole; 1,500V AC, 1 minute between contact and lamp terminals. Illumination Unit: 2,000V AC, 1 min. between live part/ground
锡焊温度/Soldering Temperature	20W/5 seconds or 260°C/3 seconds

Ø16金属防水按钮开关 Metal Waterproof Push Button Switch

名称/外观 Product appearance	带灯形式 Illuminated type	操作类别 Operation	触点 Contact	产品型号 Model	外壳材料 Crust Material
实面圆形 / Flat round 	不带灯 Without LED	自复 Momentary	1NO+1NC	J16-211	Ni:不锈钢 T:铜镀镍 G:铜镀铬 Ni:Stainless steel T: Copper Plated Ni G: Copper plated Cr
			2NO+2NC	J16-212	
		自锁 Maintained	1NO+1NC	J16-311	
			2NO+2NC	J16-312	
高面圆形 / High round 	不带灯 Without LED	自复 Momentary	1NO+1NC	J16-221	
			2NO+2NC	J16-222	
		自锁 Maintained	1NO+1NC	J16-321	
			2NO+2NC	J16-322	

平钮



单刀/1Pole
双刀/2Pole

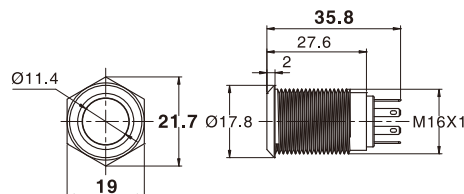

高位钮



单刀/1Pole
双刀/2Pole

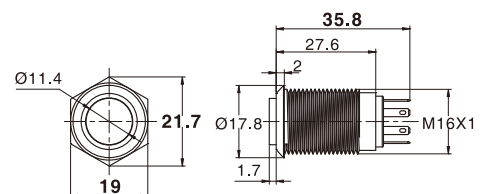

Ø16带灯金属防水按钮开关 Metal Waterproof Push Button Switch with LED

名称/外观 Product appearance	带灯形式 Illuminated type	操作类别 Operation	触点 Contact	产品型号 Model	外壳材料 Crust Material	带灯颜色 Color	额定电压 Rated Voltage
高面环形圆形 / High ring round 	带灯 With LED	自复 Momentary	1NO+1NC	J16-261 □●	Ni: 不锈钢 T: 铜镀镍 G: 铜镀铬 Ni: Stainless steel T: Copper Plated Ni G: Copper plated Cr	请用下列颜色编码 替换型号中的"□" R 红色/Red G 绿色/Green Y 黄色/Yellow W 白色/White B 蓝色/Blue	请用下列颜色编码 替换型号中的"●" D: 24VDC E: 12VDC F: 6.3VDC A1: 110VAC A2: 220VAC
			2NO+2NC	J16-262 □●			
		自锁 Maintained	1NO+1NC	J16-361 □●			
			2NO+2NC	J16-362 □●			
实面环形圆形 / Flat ring round 	带灯 With LED	自复 Momentary	1NO+1NC	J16-271 □●			
			2NO+2NC	J16-272 □●			
		自锁 Maintained	1NO+1NC	J16-371 □●			
			2NO+2NC	J16-372 □●			
实面点头圆形 / High point round 	带灯 With LED	自复 Momentary	1NO+1NC	J16-281 □●			
			2NO+2NC	J16-282 □●			
		自锁 Maintained	1NO+1NC	J16-381 □●			
			2NO+2NC	J16-382 □●			
高面点头圆形 / High point round 	带灯 With LED	自复 Momentary	1NO+1NC	J16-291 □●			
			2NO+2NC	J16-292 □●			
		自锁 Maintained	1NO+1NC	J16-391 □●			
			2NO+2NC	J16-392 □●			

J 系列三色灯金属按钮

带电源符号按钮

金属信号灯

经济型金属按钮

金属按钮

Ø12
金属按钮

Ø16
金属按钮

Ø19
金属按钮

Ø22
金属按钮

Ø25
金属按钮

Ø30
金属按钮

Ø40
金属按钮

高位钮带灯



单刀/1Pole
双刀/2Pole

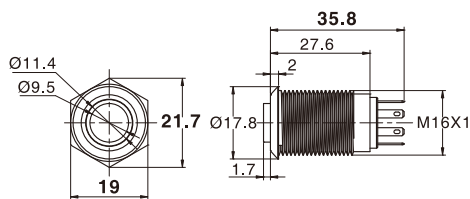

平钮带灯



单刀/1Pole
双刀/2Pole

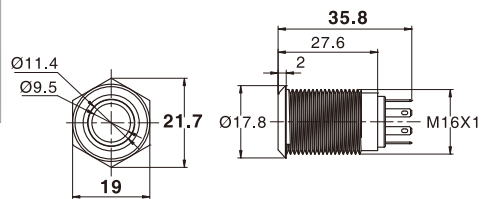

平钮带点头灯



单刀/1Pole
双刀/2Pole

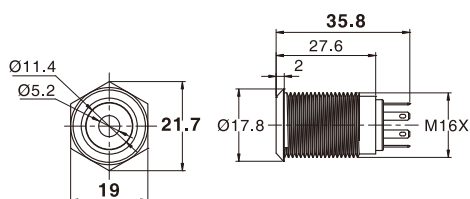

高位钮带点头灯



单刀/1Pole
双刀/2Pole

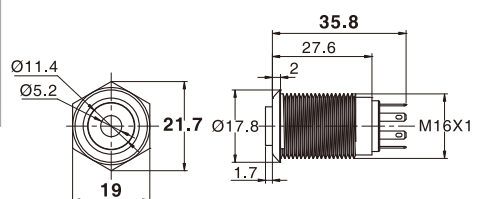

防水型金属按钮

Ø16金属防水按钮开关 Metal Waterproof Push Button Switch

名称/外观 Product appearance	带灯形式 Illuminated type	操作类别 Operation	触点 Contact	产品型号 Model	外壳材料 Crust Material
实面圆形 / Flat round 	不带灯 Without LED	自复 Momentary	1NO+1NC	J16-211-E	Ni:不锈钢 T:铜镀镍 G:铜镀铬 Ni:Stainless steel T: Copper Plated Ni G: Copper plated Cr
			2NO+2NC	J16-212-E	
		自锁 Maintained	1NO+1NC	J16-311-E	
			2NO+2NC	J16-312-E	
高面圆形 / High round 	不带灯 Without LED	自复 Momentary	1NO+1NC	J16-221-E	
			2NO+2NC	J16-222-E	
		自锁 Maintained	1NO+1NC	J16-321-E	
			2NO+2NC	J16-322-E	

Ø12
金属按钮

Ø16
金属按钮

Ø19
金属按钮

Ø22
金属按钮

Ø25
金属按钮

Ø30
金属按钮

Ø40
金属按钮

平钮



单刀/1Pole
双刀/2Pole

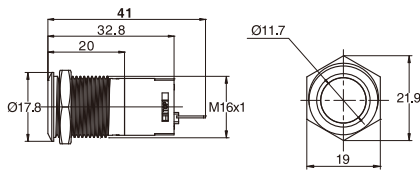

高位钮



单刀/1Pole
双刀/2Pole

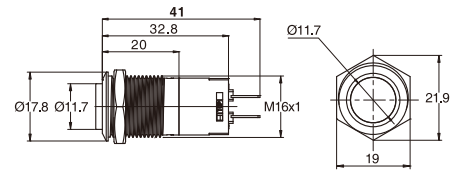

Ø16带灯金属防水按钮开关 Metal Waterproof Push Button Switch with LED

名称/外观 Product appearance	带灯形式 Illuminated type	操作类别 Operation	触点 Contact	产品型号 Model	外壳材料 Crust Material	带灯颜色 Color	额定电压 Rated Voltage
高面环形圆形 / High ring round 	带灯 With LED	自复 Momentary	1NO+1NC	J16-261-E □ ●	Ni:不锈钢 T:铜镀镍 G:铜镀铬 Ni:Stainless steel T: Copper Plated Ni G: Copper plated Cr	请用下列颜色编码 替换型号中的"□" R 红色/Red G 绿色/Green Y 黄色/Yellow W 白色/White B 蓝色/Blue	请用下列颜色编码 替换型号中的"●" D:24VDC E:12VDC F:6.3VDC A1:110VAC A2:220VAC
			2NO+2NC	J16-262-E □ ●			
		自锁 Maintained	1NO+1NC	J16-361-E □ ●			
			2NO+2NC	J16-362-E □ ●			
实面环形圆形 / Flat ring round 	带灯 With LED	自复 Momentary	1NO+1NC	J16-271-E □ ●			
			2NO+2NC	J16-272-E □ ●			
		自锁 Maintained	1NO+1NC	J16-371-E □ ●			
			2NO+2NC	J16-372-E □ ●			
实面点头圆形 / High point round 	带灯 With LED	自复 Momentary	1NO+1NC	J16-281-E □ ●			
			2NO+2NC	J16-282-E □ ●			
		自锁 Maintained	1NO+1NC	J16-381-E □ ●			
			2NO+2NC	J16-382-E □ ●			
高面点头圆形 / High point round 	带灯 With LED	自复 Momentary	1NO+1NC	J16-291-E □ ●			
			2NO+2NC	J16-292-E □ ●			
		自锁 Maintained	1NO+1NC	J16-391-E □ ●			
			2NO+2NC	J16-392-E □ ●			

J 系列三色灯金属按钮

带电源符号按钮

金属信号灯

经济型金属按钮

金属按钮

Ø12
金属按钮

Ø16
金属按钮

Ø19
金属按钮

Ø22
金属按钮

Ø25
金属按钮

Ø30
金属按钮

Ø40
金属按钮

高位钮带灯



单刀/1Pole
双刀/2Pole

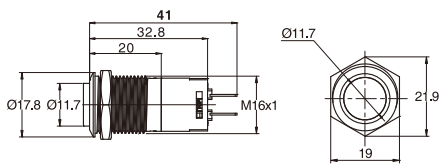

平钮带灯



单刀/1Pole
双刀/2Pole

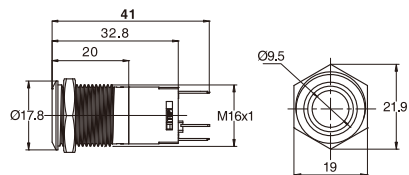

平钮带点头灯



单刀/1Pole
双刀/2Pole

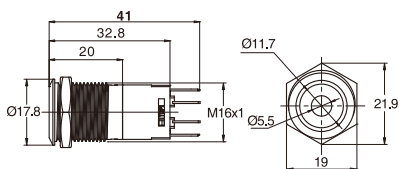

高位钮带点头灯



单刀/1Pole
双刀/2Pole

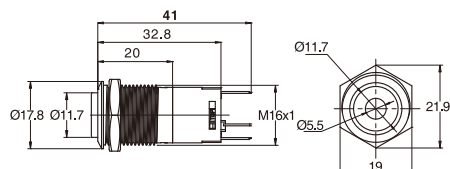

J16-E 金属按钮开关命名方式 The naming definition of J19 metal push button switch

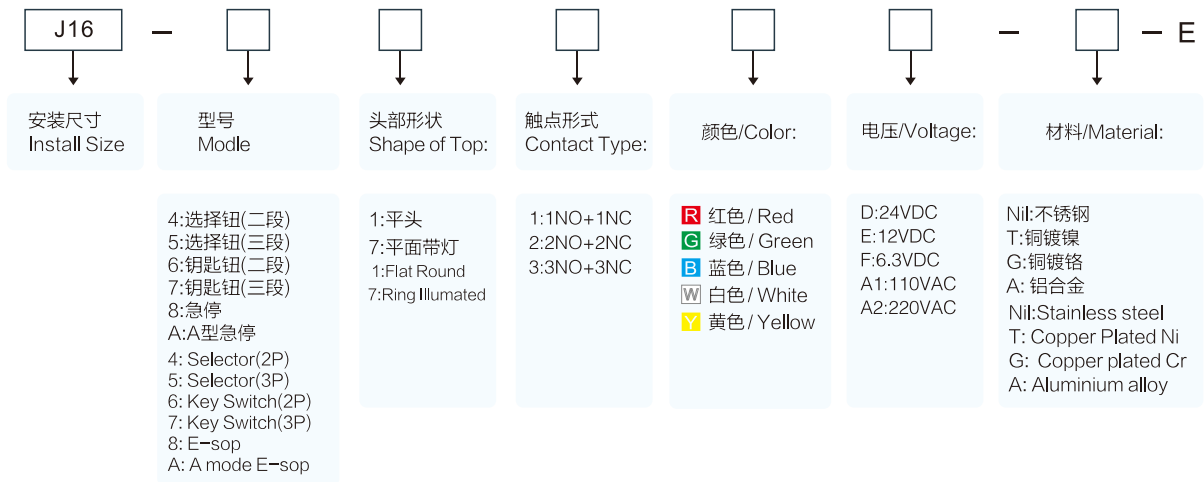

注: 常规的定制都是不锈钢外壳, 如需铜镀镍外壳, 请在型号后面加T; 如需铜镀铬外壳, 请在型号后面加G
 Note: The regular material is Stainless steel, if you want Copper Plated with Ni, please add T behind, if you want Copper Plated Cr, please add G behind.

Ø12
金属按钮

Ø16
金属按钮

Ø19
金属按钮

Ø22
金属按钮

Ø25
金属按钮

Ø30
金属按钮

Ø40
金属按钮

Ø16选择/钥匙金属开关 Selector and Key Metal Switch

通过旋转独特的锁定结构型法兰盘即可改变选择位。且, 法兰盘具备每旋转45°即可固定的锁定功能, 所以法兰盘无旋转偏移, 面板安装容易。

选择角的位置变更方法

【3位选择形状例】

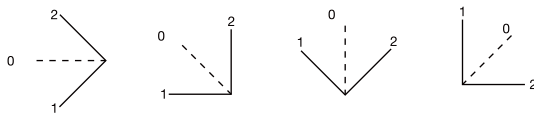

出厂时的选择位位置

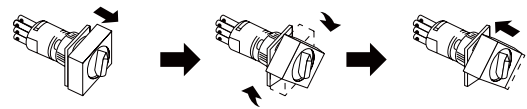

首先将法兰盘用力拉出解除锁定, 即可旋转法兰盘。选择角的位置在任意45°的位置上按下即可进行锁定。

选择钮, 钥匙钮手柄位置/Selector and Key Switch Handle Positon

操作位规格 Operation		触点 Contact	↙	↑	↗
90° 2位 2 Positon	L R 自锁 Maintained	单刀 SPDT	NO NC C		NO NC C
	L R 自复 Momentary	双刀 DPDT	NO NC NO NC C C		NO NC NO NC C C
90° 3位 3 Positon	L C R 自锁 Maintained	三刀 TPDT	NO NC NO NC C C C	NO NC NO NC C C C	NO NC NO NC C C C
	L C R 左锁右复 Left lock Right reset		NO NC NO NC C C C	NO NC NO NC C C C	NO NC NO NC C C C
	L C R 左复右锁 Left reset Right lock		NO NC NO NC C C C	NO NC NO NC C C C	NO NC NO NC C C C
	L C R 自复 Momentary		NO NC NO NC C C C	NO NC NO NC C C C	NO NC NO NC C C C

Ø16选择/钥匙金属开关 Selector and Key Metal Switch

名称/外观 Product appearance	带灯形式 Illuminated type	操作位规格 Operation	触点 Contact	产品型号 Model	带灯颜色 Color	额定电压 Rated Voltage
选择开关 Selector Switch 	不带灯 Without LED	90° 2位 2 Positon	单刀/SPDT	J16-411-E	请用下列颜色编码 替换型号中的"□" R 红色/Red G 绿色/Green Y 黄色/Yellow W 白色/White B 蓝色/Blue	请用下列颜色编码 替换型号中的"●" D:24VDC E:12VDC F:6.3VDC A1:110VAC A2:220VAC
		90° 3位 3 Positon	双刀/DPDT	J16-412-E		
	带灯 With LED	90° 2位 2 Positon	单刀/SPDT	J16-471-E □ ●		
		90° 3位 3 Positon	双刀/DPDT	J16-472-E □ ●		
钥匙开关 Key Switch 		自锁 Maintained	90° 2位 2 Positon	单刀/SPDT	J16-611-E	
			90° 3位 3 Positon	双刀/DPDT	J16-612-E	
				双刀/DPDT	J16-712-E	

选择开关

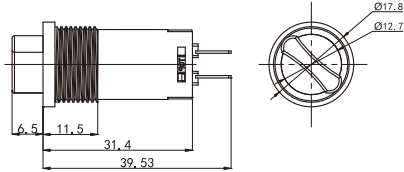

钥匙开关

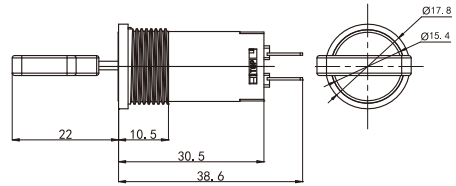

J系列三色灯金属按钮

带电源符号按钮

金属信号灯

经济型金属按钮

金属按钮

Ø12
金属按钮

Ø16
金属按钮

Ø19
金属按钮

Ø22
金属按钮

Ø25
金属按钮

Ø30
金属按钮

Ø40
金属按钮